

## 18.2 CU-3E18PBE CU-4E23PBE

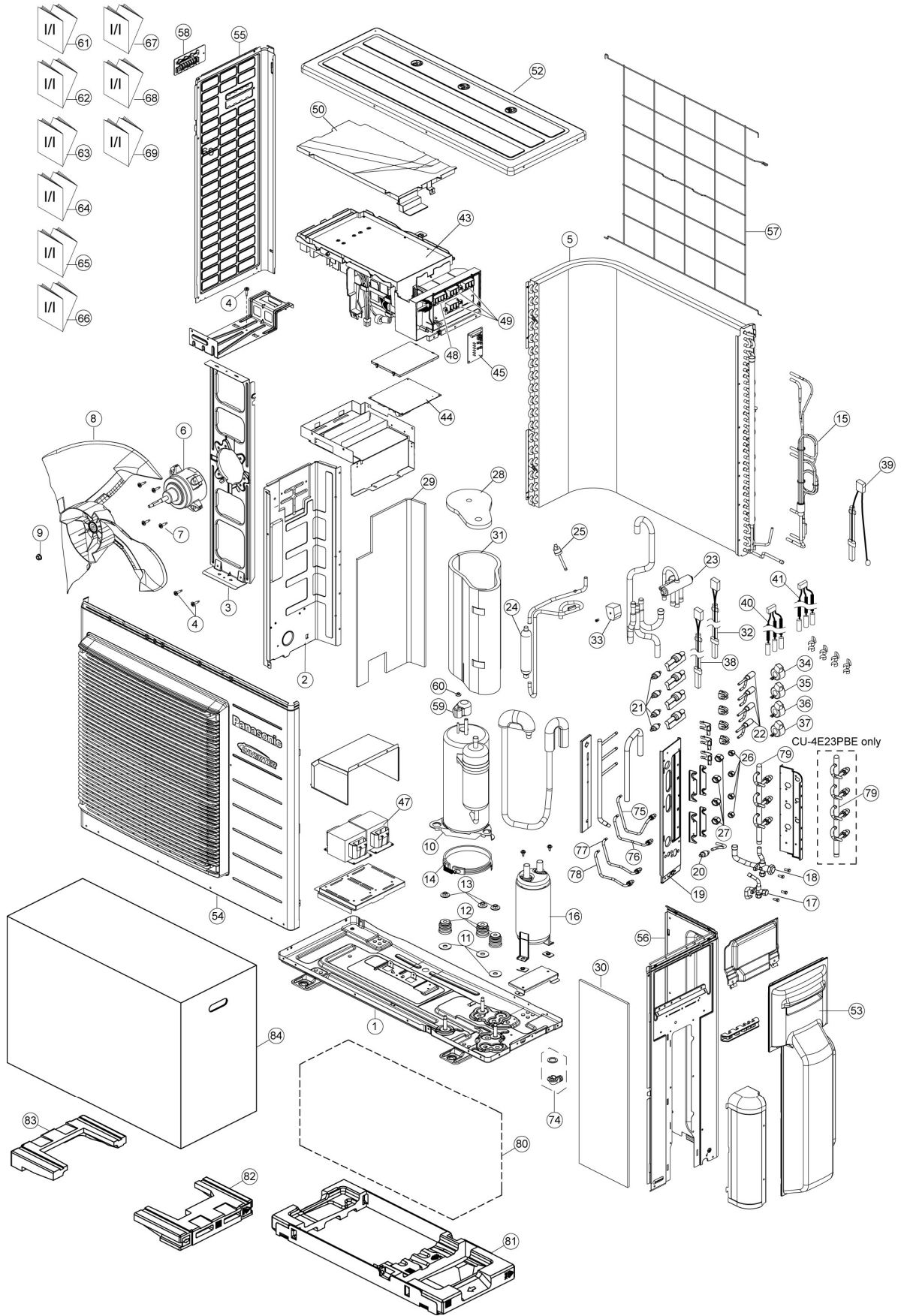

**Note**

The above exploded view is for the purpose of parts disassembly and replacement.  
 The non-numbered parts are not kept as standard service parts.

SAFETY	REF. NO.	DESCRIPTION & NAME	QTY.	CU-3E18PBE	CU-4E23PBE	REMARK
	1	CHASSIS ASSY	1	CWD52K1212	←	
	2	SOUND PROOF BOARD	1	CWH151194	←	
	3	FAN MOTOR BRACKET	1	CWD541127	←	
	4	SCREW-BRACKET FAN MOTOR	3	CWH551217	←	
	5	CONDENSER COMPLETE	1	CWB32C2680	←	
⚠	6	FAN MOTOR DC 60W 3PH	1	EHDS80C60AC	←	O
	7	SCREW-FAN MOTOR MOUNT	4	CWH551323	←	
	8	PROPELLER FAN ASSY	1	CWH00K1006	←	
	9	NUT	1	CWH561092	←	
⚠	10	COMPRESSOR	1	5KD184XAB21	←	
	11	PACKING	3	CWB81043	←	
	12	BUSHING - COMPRESSOR MOUNT	3	CWH50055	←	
	13	NUT-COMPRESSOR MOUNT	3	CWH561049	←	
	14	CRANKCASE HEATER	1	CWA341047	←	
	15	TUBE ASSY (CAPILLARY TUBE)	1	CWT01C4955	←	
	16	ACCUMULATOR	1	CWB131050	←	
	17	3-WAY VALVE	1	CWB011601	←	
	18	3-WAY VALVE	1	CWB011602	←	
	19	HOLDER COUPLING	1	CWH351141	←	
	20	STRAINER	1	CWB11061	←	
	21	STRAINER	3/4	CWB111024	←	
	22	EXPANSION VALVE	3/4	CWB051029	←	
	23	4-WAYS VALVE	1	CWB001026J	←	
	24	DISCHARGE MUFFLER	1	CWB121014	←	
	25	HEATING PRESSURE SWITCH	1	CWA101007	←	
	26	FLARE NUT (1/4)	3/4	CWT251030	←	
	27	FLARE NUT (3/8)	3/4	CWT251031	←	
	28	SOUND PROOF MATERIAL	1	CWG302246	←	
	29	SOUND PROOF MATERIAL	1	CWG302520	←	
	30	SOUND PROOF MATERIAL	1	CWG302521	←	
	31	SOUND PROOF MATERIAL	1	CWG302522	←	
	32	SENSOR COMPLETE - DIS	1	CWA50C2515	←	O
⚠	33	V-COIL COMPLETE (4 WAY VALVE)	1	CWA43C2551	CWA43C2169J	O
⚠	34	V-COIL COMPLETE (EXPAND VALVE-WHITE)	1	CWA43C2334	←	O
⚠	35	V-COIL COMPLETE (EXPAND VALVE-YELLOW)	1	CWA43C2335	←	O
⚠	36	V-COIL COMPLETE (EXPAND VALVE-BLUE)	1	CWA43C2336	←	O
⚠	37	V-COIL COMPLETE (EXPAND VALVE-RED)	1	-	CWA43C2338	O
	38	SENSOR-COMPLETE - DEF	1	CWA50C2625	←	O
	39	SENSOR COMPLETE (OUTLET TEMP SENSOR)	1	CWA50C2517	←	O
	40	SENSOR-COMPLETE (CN-TH4)	1	CWA50C2620	CWA50C2616	O
	41	SENSOR-COMPLETE (CN-TH3)	1	CWA50C2622	CWA50C2617	O
⚠	43	ELECTRONIC CONTROLLER	1	CWA73C7219R	CWA73C7220R	O
⚠	44	ELECT. CONTROLLER -NOISE FILTER	1	CWA745291	←	O
⚠	45	ELECTRONIC CONTROLLER (DISPLAY)	1	CWA745292	←	O
⚠	47	REACTOR	2	G0C403J00001	←	
⚠	48	TERMINAL BOARD ASSY	1	CWA28K1195	←	
⚠	49	TERMINAL BOARD ASSY	4	CWA28K1196	←	
	50	CONTROL BOARD COVER	1	CWH131333	←	
	52	CABINET TOP PLATE	1	CWE031083A	←	
	53	CONTROL BOARD COVER	1	CWH13C1194	←	
	54	CABINET FRONT PLATE	1	CWE06K1065	←	
	55	CABINET SIDE PLATE	1	CWE041317A	←	
	56	CABINET SIDE PLATE	1	CWE041395A	←	
	57	WIRE NET	1	CWD041128A	←	
	58	HANDLE	1	CWE161010	←	

	REF. NO.	DESCRIPTION & NAME	QTY.	CU-3E18PBE	CU-4E23PBE	REMARK
	59	TERMINAL COVER	1	CWH171035	←	
	60	NUT-TERMINAL COVER	1	CWH7080300J	←	
	61	INSTALLATION INSTRUCTION	1	CWF615715	←	
	62	INSTALLATION INSTRUCTION	1	CWF615716	←	
	63	INSTALLATION INSTRUCTION	1	CWF615717	←	
	64	INSTALLATION INSTRUCTION	1	CWF615718	←	
	65	INSTALLATION INSTRUCTION	1	CWF615719	←	
	66	INSTALLATION INSTRUCTION	1	CWF615720	←	
	67	INSTALLATION INSTRUCTION	1	CWF615721	←	
	68	INSTALLATION INSTRUCTION	1	CWF615722	←	
	69	INSTALLATION INSTRUCTION	1	CWF615723	←	
	74	ACCESSORY CO. (DRAIN ELBOW)	1	CWG87C900	←	
	75	TUBE ASS'Y (LIQUID 1)	1	CWT026282	←	
	76	TUBE ASS'Y (LIQUID 2)	1	CWT026283	←	
	77	TUBE ASS'Y (LIQUID 3)	1	CWT026284	←	
	78	TUBE ASS'Y (LIQUID 4)	1	-	CWT026285	
	79	MANIFOLD TUBE ASS'Y (GAS SIDE)	1	CWT07K1480	CWT07K1476	
	80	BAG	1	CWG861154	←	
	81	BASE BOARD-COMPLETE	1	CWG62C1081	←	
	82	SHOCK ABSORBER (R)	1	CWG712879	←	
	83	SHOCK ABSORBER (L)	1	CWG712880	←	
	84	C.C. CASE	1	CWG565546	←	

(Note)

- All parts are supplied from PAPAMY, Malaysia (Vendor Code: 00029488).
- "O" marked parts are recommended to be kept in stock.